

Licensing Panel (Licensing Act 2003 Functions)

Date: **22 November 2024**

Time: **10.00am**

Venue **Virtual**

Members: **Councillors: Cattell, Nann and Thomson**

Contact: **Francis Mitchell**
Democratic Services Officer
01273 294183
Francis.Mitchell@brighton-hove.gov.uk

Agendas and minutes are published on the council's website www.brighton-hove.gov.uk.
Agendas are available to view five working days prior to the meeting date.

Electronic agendas can also be accessed through our meetings app available through
ModernGov: [iOS/Windows/Android](#)

This agenda and all accompanying reports are printed on recycled paper

AGENDA

1 TO APPOINT A CHAIR FOR THE MEETING

WELCOME & INTRODUCTIONS

2 PROCEDURAL BUSINESS

(a) **Declaration of Substitutes:** Where Councillors are unable to attend a meeting, a substitute Member from the Licensing Committee may attend, speak and vote in their place for that meeting.

(b) **Declarations of Interest:**

- (a) Disclosable pecuniary interests;
- (b) Any other interests required to be registered under the local code;
- (c) Any other general interest as a result of which a decision on the matter might reasonably be regarded as affecting you or a partner more than a majority of other people or businesses in the ward/s affected by the decision.

In each case, you need to declare

- (i) the item on the agenda the interest relates to;
- (ii) the nature of the interest; and
- (iii) whether it is a disclosable pecuniary interest or some other interest.

If unsure, Members should seek advice from the committee lawyer or administrator preferably before the meeting.

(c) **Exclusion of Press and Public:** To consider whether, in view of the nature of the business to be transacted, or the nature of the proceedings, the press and public should be excluded from the meeting when any of the following items are under consideration.

NOTE: Any item appearing in Part Two of the Agenda states in its heading the category under which the information disclosed in the report is exempt from disclosure and therefore not available to the public.

A list and description of the exempt categories is available for public inspection at Brighton and Hove Town Halls.

3 FIKA LICENSING PANEL (LICENSING ACT 2003 FUNCTIONS)

7 - 32

Contact Officer: Levente Nagy

Ward Affected: Central Hove

Date of Publication - Thursday, 14 November 2024

The City Council actively welcomes members of the public and the press to attend its meetings and holds as many of its meetings as possible in public. Provision is also made on the agendas for public questions to committees and details of how questions can be raised can be found on the website and/or on agendas for the meetings.

The closing date for receipt of public questions and deputations for the next meeting is 12 noon on the fourth working day before the meeting.

Meeting papers can be provided, on request, in large print, in Braille, on audio tape or on disc, or translated into any other language as requested.

Infra-red hearing aids are available for use during the meeting. If you require any further information or assistance, please contact the receptionist on arrival.

FURTHER INFORMATION

For further details and general enquiries about this meeting contact Francis Mitchell, (01273 294183, email Francis.Mitchell@brighton-hove.gov.uk) or email democratic.services@brighton-hove.gov.uk

WEBCASTING NOTICE

This meeting may be filmed for live or subsequent broadcast via the Council's website. At the start of the meeting the Chair will confirm if all or part of the meeting is being filmed. You should be aware that the Council is a Data Controller under the Data Protection Act 1998. Data collected during this web cast will be retained in accordance with the Council's published policy.

Therefore, by entering the meeting room and using the seats in the chamber you are deemed to be consenting to being filmed and to the possible use of those images and sound recordings for the purpose of web casting and/or Member training. If members of the public do not wish to have their image captured, they should sit in the public gallery area.

ACCESS NOTICE

The Public Gallery is situated on the first floor of the Town Hall and is limited in size but does have 2 spaces designated for wheelchair users. The lift cannot be used in an emergency. Evac Chairs are available for self-transfer and you are requested to inform Reception prior to going up to the Public Gallery. **For your own safety please do not go beyond the Ground Floor if you are unable to use the stairs.**

Please inform staff on Reception of this affects you so that you can be directed to the Council Chamber where you can watch the meeting or if you need to take part in the proceedings e.g. because you have submitted a public question.

FIRE / EMERGENCY EVACUATION PROCEDURE

If the fire alarm sounds continuously, or if you are instructed to do so, you must leave the building by the nearest available exit. You will be directed to the nearest exit by council staff. It is vital that you follow their instructions:

- You should proceed calmly; do not run and do not use the lifts;
- Do not stop to collect personal belongings;
- Once you are outside, please do not wait immediately next to the building, but move some distance away and await further instructions; and
- Do not re-enter the building until told that it is safe to do so.

Licensing Panel (Licensing Act 2003 Functions)

Brighton & Hove City Council

Subject:	Application for a New Premises Licence under the Licensing Act 2003		
Premises:	Fika 1 Victoria Grove, Hove, BN3 2LJ		
Applicant:	Fika Ave Ltd		
Date of Meeting:	22 November 2024		
Report of:	Corporate Director for City Services		
Contact Officer:	Name:	Emily Fountain	Tel: (01273) 292143
	Email:	emily.fountain@brighton-hove.gov.uk	
Ward(s) affected:	Central Hove		

1. PURPOSE OF REPORT AND POLICY CONTEXT

- 1.1 To determine an application for a New Premises Licence under the Licensing Act 2003 for Fika

2. RECOMMENDATIONS:

- 2.1 That the Panel determine an application for a New Premises Licence under the Licensing Act 2003 for Fika.

3. CONTEXT/BACKGROUND INFORMATION & CONSULTATION

- 3.1 The application is for a New Premises Licence under the Licensing Act 2003. The application proposes

Cafe and eatery with 40 internal seats and 30 external seats, looking to obtain a premises licence for on sale only

- 3.2 Section 18 (Operating Schedule) of the application is detailed at Appendix A and the plan of the premises is attached at Appendix B

3.3 Summary table of proposed activities

	Proposed
Recorded Music	Indoors Every Day: 07:00 – 21:00
Supply of Alcohol	On the Premises Every Day: 09:00 – 21:00
Hours premises are open to public	Every Day: 07:00 – 21:00

- 3.4** Special Stress Area: The premises falls within the Special Stress Area. This area is deemed an area of special concern in terms of the levels of crime, disorder, and public nuisance experienced within them. (See paragraphs 3.2 – 3.2.5)

Representations received

- 3.5** Details of the representations made are notified to applicants on receipt by the Licensing Authority using a pro-forma. A summary appears below:
- 3.6** 2 representations were received. They were received from local residents.
- 3.7** Representations received had concerns relating to Prevention of Public Nuisance.
- 3.8** Full details of the representations are attached at Appendix C. Conditions agreed with Sussex Police are attached at Appendix D. A map detailing the location of the premises is attached at Appendix E.

4. COMMENTARY ON THE LICENSING POLICY

- 4.1** The following extracts from Brighton & Hove City Council Statement of Licensing Policy are considered relevant to this application and **are numbered as they appear in the policy**:

1 Introduction

1.1 This Statement of Licensing Policy has been prepared in accordance with the provisions of the Licensing Act 2003 (the Act) and having regard to Guidance issued by the Home Office under Section 182 of the act. This policy takes effect from the 4th February 2021. The licensing authority is Brighton & Hove City Council. The purpose of this statement is to promote the licensing objectives and set out a general approach to making licensing decisions. The discretion of the licensing authority in relation to applications under the act is only engaged if 'relevant

representations' are made by other persons or responsible authorities. This policy will inform the approach to be taken when deciding applications and imposing conditions when relevant representations are received. It is also intended as a guide for applicants as to what to include in their operating schedules, always recognising that if no representations are received, the application must be granted. The licensing authority must carry out its functions with a view to promoting the licensing objectives and this policy is framed around those objectives. Each application will be given individual consideration on its merit. The scope of this policy covers the following:

- Retail sales of alcohol.
- The supply of alcohol by or on behalf of a club, or to the order of, a member of the club.
- The provision of regulated entertainment.
- The provision of late night refreshment.

1.2 The licensing objectives are:

- (a) the prevention of crime and disorder.
- (b) public safety.
- (c) the prevention of public nuisance; and
- (d) the protection of children from harm.

1.3 Scope

1.3.1 Licensing is about regulating licensable activities on licensed premises, by qualifying clubs and at temporary events. Any conditions attached to various authorisations will be focused on matters which are within the control of individual licensees and others with relevant authorisations, i.e. the premises and its vicinity. Each application will be given individual consideration on its merit. Nothing in this policy shall undermine the right of any individual to apply under the terms of the act for a variety of permissions and to have any such application considered on its individual merits. Similarly, nothing in this policy shall override the right of any person to make representations on an application or seek a review of a licence or certificate where provision has been made for them to do so in the act.

3 Special Policies and Initiatives

3.2 Special Stress Area

3.2.1 The map below details the area of the city centre which borders the Cumulative Impact zone at 3.1.3 and which is deemed an area of special concern in terms of the levels of crime and disorder and public nuisance experienced within it. The area recommended for further monitoring and detailed guidance within the Special Policy comprise the following as pictured below delineated in purple:

Special Stress Area and Cumulative Impact Zone, January 2021

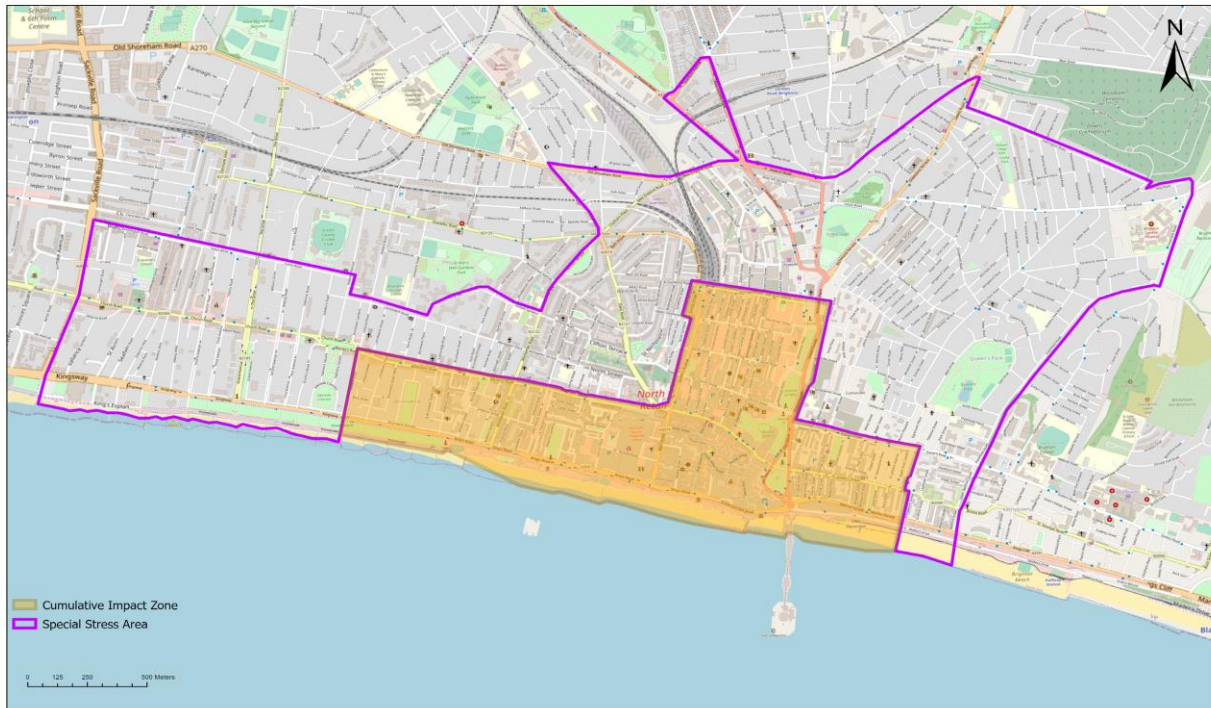

Brighton & Hove Public Health Intelligence, 2021
© OpenStreetMap (and) contributors, CC-BY-SA © Crown Copyright. All rights reserved. Licence: 100020999. Brighton & Hove City Council. 2019. Cities Revealed © 2018

The Special Stress Area - an area bounded by and including: The west side of Hove Street/Sackville Road, northwards to the intersection with the north side of Blatchington Road, along north side of Blatchington Road and Eaton Road, southwards at the junction onto the east side of Palmeira Avenue and then eastwards at the junction onto the north side of Landsdowne Road; eastwards to the junction with Furze Hill, along the north side Furze Hill to its end and then due east along the north side of Victoria Road to its junction with Montpelier Road (west side), north to where Montpelier Road joins Vernon Terrace then north to Seven Dials; north west along the west side of Dyke Road until the junction with the Old Shoreham Road, then East along the north side of Old Shoreham Road, continuing on the north end of New England Road, north west at Preston Circus at the junction of New England Road and Preston Road along the west side of Preston Road until the junction with Stanford Avenue then and north east along the north side of Stanford Avenue until the junction with Beaconsfield Road, south along the east side of Beaconsfield Road until the junction at Preston Circus and Viaduct Road, eastwards along the north side of Viaduct Road, then at the junction with Ditchling Road, North East along the north side of Upper Lewes Road until the junction with Lewes Road; south along the Lewes Road to junction with Hartington Road, along the north side of Hartington Road until the junction with St. Helen's Road, south into the north side of May Road, eastwards until its junction with Freshfield Road (east side), then south into Upper Bedford Street, into Bedford Street to the mean water mark south of Bedford Street, then due west until the mean water mark south of Lower Rock Gardens; North on Upper Rock gardens, to the north side of Eastern Road, west along Eastern Road and Edward Street until Grand Parade, north along the Eastern side of Grand Parade to the junction of York Place and Trafalgar Street, West along the Northern boundary of Trafalgar Street, up to and including Surrey Street and then South along the Western boundary of Queens Road to the junction with Air Street, West along the north side of Air Street, South-west to the junction of Western Road Brighton, then West along the North side of Western Road Brighton, South along the West side of Holland Road to the mean water mark south of Kingsway and Kingsway Esplanade as far as the west side of Hove Street/ Sackville Road.

3.2.2 This Special Stress Area (SSA) is of concern to the licensing authority because of the relatively high levels of crime and disorder and nuisance experienced within it. The area will be kept under review.

3.2.3 New and varied applications for premises and club premises certificates within the SSA will not be subject to the presumption of refusal, but operators will be expected to pay special attention when drawing up their operating schedules and to make positive proposals to ensure that their operation will not add to the problems faced in these areas. Appendix A of the SoLP sets out a list of potential measures the licensing authority considers may be appropriate. These may be more or less appropriate depending upon the style of operation applied for.

3.2.4 On receipt of any application in the SSA, where a relevant representation has been made, the licensing authority will scrutinise the application carefully and will look at the measures proposed in the operating schedules and compare them to the measures set out in Appendix A, Licensing Best Practice Measures. Where discretion has been engaged, those applications which fall short may be refused or conditions applied to comply with policy measures.

3.2.5 The Licensing Authority will keep the Cumulative Impact Zone and Special Stress Area under review. Should the authority find that problems of crime and disorder or nuisance are not improving, or are worsening, the Special Policy will be reviewed.

3.3 The Matrix Approach

The Licensing Authority will support:

3.3.1 Diversity of premises: ensures that there is a mix of the different types of licensed premises and attracts a more diverse range of customers from different age groups, different communities and with different attitudes to alcohol consumption. It gives potential for positively changing the ambience of the city or an area of it. This will have a positive effect in reducing people's fear of crime and in increasing the number of evening visitors to the city centre. The Community Safety Strategy recognises that too many single uses in a confined area and patrons turning out onto the streets at the same time may create opportunities for violent crime and public disorder and therefore supports mixed use venues encouraging a wider age balance.

3.3.2 A "matrix" approach to licensing decisions has been adopted and is set out below. It provides a framework of what the licensing authority would like to see within its area and gives an indication of the likelihood of success or otherwise to investor and businesses making applications.

Matrix approach for licensing decisions in a Statement of Licensing Policy (times relates to licensable activities)

	Cumulative Impact Area	Special Stress Area	Other Areas
Restaurant	Yes (midnight)	Yes (midnight)	Yes (midnight)
Café	Yes (10 pm)	Yes (10 pm)	Yes (10 pm)
Late Night Takeaways	No	Yes (midnight)	Yes (midnight)
Night Club	No	No	No
Pub	No	Yes (11pm)	Yes (midnight)
Non-alcohol lead (e.g. Theatre)	Yes (favourable)	Yes (favourable)	Yes (favourable)
Off-licence	No	No	Yes (Up to 11pm but if in densely residential area may be earlier – see note 7 below)
Members Club (club premises certificate)	Yes (<100 capacity) (11pm)	Yes (<100 capacity) (11pm)	Yes

Notes on matrix

Subject to the following notes, the policy, as represented in the matrix, will be strictly adhered to:

- 1) Each application will be considered on individual merit
- 2) Applications within the CIZ are subject to the special policy on cumulative impact at para 3.1, and those within the special stress area to the special stress policy considerations at para 3.2.
- 3) Departure from the matrix policy is expected only in exceptional circumstances
- 4) Exceptional circumstances will not include quality of management or size of venue except where explicitly stated in policy matrix.
- 5) Exceptional circumstances may include: consultation with and meeting requirements of responsible authorities, an appropriate corporate social responsibility policy, community contribution to offset impact (such as financial contribution to infrastructure), community support, alcohol sale ancillary to business activity (demonstrable to responsible authorities and licensing authority, for instance by licence condition allowing authorised officers access to sales accounts).

6) The following licensing activities are encouraged and valued by the licensing authority: outdoor regulated entertainment, community based street parties, members clubs, traditional pubs outside the city centre and non-alcohol led licensable activities, particularly within city centre.

7) Other Areas; consideration will be given to the nature of the area and location in relation to any application. In a residential area for example the concerns of local residents will be relevant when considering applications for off-licences, pubs or cafes, especially if there is evidence of anti-social behaviour, street drinking or underage drinking. Earlier closing times may be appropriate. Regard will be had to the Public Health Framework for assessing alcohol licensing on our website www.brighton-hove.gov.uk/licensingact.

8) In an area where there are already several existing off-licences or where the premises is situated within a parade with another off licence and where representations are received about negative cumulative impact on the licensing objectives of a further premises, the application may be refused on these grounds or restrictions placed on the terminal hour to reflect opening hours of other shops.

9) Outdoor events will be supported where arranged through the council's event planning process. Generally, regulated entertainment in the open air including tents and marquees should have a maximum closure hour of 2300. Earlier hours may be imposed in sensitive open spaces or near residential areas. The licensing authority will have regard to Noise Council guidance.

10) Non-alcohol led category does not include "alcohol in shared workplaces". It is recommended that sale of alcohol in shared workspaces should have a terminal hour of no later than 10pm. For further advice and guidance on "alcohol in shared workplaces" please see paragraph 3.3.4-3.3.6.

3.3.3 Cafes - the licensing authority may be prepared to look favourably upon an application for the grant of a licence, subject to the following conditions that will prevent the premises becoming a public house.

- The sale of intoxicating liquor and other beverages shall be waiter/waitress service for consumption by persons seated at tables.
- Substantial food shall be available at all times. The licensing authority shall judge each case on its own merits but as a general rule, a bowl of crisps, nuts, or olives does not constitute substantial food.

3.9 Promoters and irresponsible drinks promotions

3.9.1 The Licensing Act 2003 makes no mention or provision for the use of promoters within licensed premises. Many of the late night bars and clubs within the Brighton & Hove Cumulative Impact Zone regularly hire promoters to sell nights at their venues. In recent years with the introduction of promoters within the Brighton night time economy, several issues have arisen. This includes promoters vouching for underage customers to get them inside licensed premises where they can access alcohol, providing flyers to passers-by who throw them on the floor and irresponsible promotions for their nights. Many premises now have an agreement

with their promoter for acceptable promotions and behaviour which includes the signing of a written contract of expectations. This shows premises evidencing their due diligence and ensures that promotion companies know what is expected of them. The contract could include, obligations to pick up self-generated litter, verification of ages of their customers and users of their social media, promoters being over the age of 18 and responsible advertising on social media.

3.9.2 The Licensing Authority expect licensed premises to develop staff policy and training on recognising signs of drunkenness and vulnerability, for example, offering drinking water and tips for refusing customers who appear drunk. And discourage company policies that promote bonuses and sales incentives for selling alcohol. Licensing Authority will expect necessary precautionary processes to restrict drunkenness, e.g. Licensing Guidance states happy hours should not be designed to encourage individuals to drink excessively or rapidly.

6 Prevention of Public Nuisance

The following details and measures are intended to address the need for the prevention of public nuisance which may be associated with licensed premises and certificated club premises:

6.1.1 In determining applications for new and varied licences, regard will be had to the location of premises, the type and construction of the building and the likelihood of nuisance and disturbance to the amenity of nearby residents by reason of noise from within the premises, as a result of people entering or leaving the premises or from individuals or groups of customers gathered outside (eg in order to smoke).

6.1.2 Applications for new licences or for the extension in size of licensed premises should not normally be granted if the premises will use amplified or live music and operate within or abutting premises containing residential accommodation except that occupied by staff of the licensed premises. A condition may be imposed on new licences that entertainment noise shall be inaudible in any residence. Noise emanating from within licensed premises should not normally be audible outside.

6.1.3 Installation of sound limiting equipment and sound insulation may be required to minimise disturbance to the amenity of nearby residents by reason of noise from the licensed premises.

6.1.4 Generally, regulated entertainment in the open air including tents and marquees should have a maximum closure hour of 2300. Earlier hours may be imposed in sensitive open spaces or near residential areas. The Licensing Authority will have regard to Noise Council guidance.

6.1.5 In determining applications for new licences or extensions in hours or terminal hours of licensed premises, regard will be had to late night public transport availability and location of taxi ranks to aid dispersal of customers.

6.1.6 Reasonable controls are available to all premises operators to minimise the impact of noise from customers outside. The council's Environmental Health Department has issued guidance on a number of steps that can be taken in this respect which are endorsed by this policy (see 6.2 below).

6.2 Smoking Advice

6.2.1 Premises licence holders will be expected to:

- Develop a management plan on how to manage smoking on your premises and ensure that all staff are aware of the contents of this plan, and that it is effectively implemented. Noise from people smoking and talking can be intermittent, vary in character and volume and be intrusive. An effective smoking management plan will help prevent neighbours being disturbed.
- Comply with any planning conditions restricting the use of outdoor areas.
- Ensure that any structures used by smokers comply with the design criteria detailed in the Heath Act 2006 and that any structures, awnings, retractable canopies, etc. have the relevant planning permission.
- Ensure any new lighting to outdoor areas must be designed so as not to cause a light nuisance to neighbours and again have the relevant planning permission and building control consent.
- Ensure that the conditions on the premises licence are complied with. There may be conditions restricting the hours of use of gardens and outdoor areas. Having reviewed the contents of the premises licence you may find it necessary to request a variation of your licence.
- Licence tables and chairs on the Public Highway under the provisions of the Highways Act 1980. These licences may have conditions restricting the times that the area can be used.
- Ensure drinks, glasses and bottles are not taken onto the highway unless there is a tables and chairs licence permitting use. A system should be adopted to prevent theft and 'spiking' of drinks and reminding customers not to leave unattended items.
- Discourage smokers remaining in gardens and outdoor areas and determine terminal hours.
- Discourage smokers remaining outside by removing/disabling tables and chairs or prohibiting their use after a certain time. Lights and heaters will also be turned off.
- Introduce a system that after a certain time the number of smokers outside are restricted to a maximum number. Staff will be needed to manage this restriction.
- Employ staff and/or SIA registered door supervisors to manage doors and control customers and smokers entering and leaving the premises. Staff positioned on the doors can help to encourage customers not to cause a noise problem. It may be that staff are required to manage doors after a certain time, particularly during the hours when neighbouring residents are trying to sleep.
- Ensure door supervisors maintain order outside venues and protect customer safety. BCRP supports the use of Night Safe. Radio net and

other pager systems and pub watch schemes can be used to provide for rapid police response and alert other venues where customers and staff are endangered.

- Position signs to remind customers that the premises is in an area where people live. It is not always obvious in busy commercial streets with flats above. By changing the design and wording of signs customers do not forget. Signs can be located in and outside the premises and on tables.
- Use CCTV to manage outside areas.

6.2.2 Licensed premises should normally display prominent, legible signs at exits reminding customers to leave in a quiet, peaceful, orderly manner.

8 Integration of Strategies

8.1.1 The licensing authority shall secure the proper integration of this policy with local crime prevention, planning policy, transport, tourism and cultural strategies by:-

- Liaising and consulting with the Sussex Police, Community Safety Forum, Sustainability Commission representatives and following the guidance in community safety and crime and disorder strategy
- Liaising and consulting with Public and Alcohol Programme Board
- Liaising and consulting with the East Sussex Fire & Rescue Service
- Liaising and consulting with the Local Strategic Partnership, Safety Advisory Group (Emergency Planning) and Equalities and Social Justice Consultation Forum
- Liaising and consulting with the Planning authority
- Liaising and consulting with the Highways authority
- Liaising and consulting with local business and business associations. Having regard to any future documents issued relating to the Private Security Industry Act 2001, for example liaison or information sharing protocols
- Liaising and consulting with the Trading Standards Team, for example with regard to test purchasing codes of practice

8.1.2 In line with statutory requirements and the council's Inclusion Policy, the Licensing Authority shall have due regard to the need to eliminate unlawful discrimination, and to promote equality of opportunity and positive relations between persons of diverse backgrounds, for example communities of interest such as: lesbian, gay, bisexual and transgender people; disabled people; racial and ethnic groups; religious and faith groups.

8.1.3 This policy supports the aims of the tourism strategy, recognising the benefits for the tourism economy of creating a safer and more attractive city centre and improving competitiveness with other European cities. The Licensing Committee should receive any reports relevant to the needs of the local tourist economy and the cultural strategy for the area to ensure that it considers these matters.

8.1.4 The Licensing Committee should receive relevant information relating to the employment situation of the area and the need for new investment and employment where appropriate.

8.1.5 Specific conditions may be attached to premises licences to reflect local crime prevention strategies. Such conditions may include the use of closed circuit television cameras, use of the NightSafe radio system or accredited scheme, the provision and use of shatterproof drinking receptacles, drugs and weapons search policy, the use of registered door supervisors, specialised lighting requirements, hours of opening. Certificates issued to club premises shall reflect local crime prevention strategies and may include any or all of the requirements listed above.

8.1.6 The licensing authority will have regard to the need to disperse people quickly and safely from the city centre to avoid concentrations which may produce disorder and disturbance.

8.3 Enforcement

8.3.1 The Enforcement of licensing law and inspection of licensed premises is detailed in the Protocol between Sussex Police, the East Sussex Fire & Rescue Service and Brighton & Hove City Council. This protocol reflects the need for more efficient deployment of Police and Local Authority staff commonly engaged in licensing enforcement and can be found at Appendix D (Lead Agency Status) of the Statement of Licensing Policy. In addition, the Licensing Authority will have regard to its published Licensing Enforcement Policy in making enforcement decisions in accordance with Brighton & Hove City Council's Statement of Licensing Policy (Appendix B). In order to better target enforcement resources, inspections will be undertaken outside of normal office hours and the sharing of information between all enforcement agencies will be encouraged through joint meetings or similar arrangements.

8.3.2 Attention is drawn to the targeting of agreed problem and high risk premises requiring greater attention as identified in the protocol. A number of other council and government policies, strategies and guidance documents must be taken into account to complement the policy, including:

- Community Safety & Crime Reduction Strategy
- Drugs and alcohol strategies – local alcohol harm reduction strategy
- Objectives of the Security Industry Authority
- The Anti-Social Behaviour Act 2003/ASBPC Act 2014
- The Health Act 2006
- The Violent Crime Reduction Act 2006
- Policing and Crime Act 2009

10 Live Music, Dancing & Theatre

10.1.1 This policy recognises the need to encourage live music, dancing and theatre for the wider cultural benefits of the community generally. In addressing such issues the potential for limited disturbance in neighbourhoods will always be carefully balanced with these wider benefits, particularly for children. The impact of licensing on regulated entertainment, particularly live music and dancing, will be monitored.

Where indications are that such events are being deterred by licensing requirements, the policy will be revisited with a view to investigating how such situations might be reversed.

10.1.2 The Licensing Committee represents the general interests of a community in determining what conditions should be attached to licences and certificates as a matter of necessity for the promotion of the licensing objectives. All members of the Licensing Committee will be trained on Licensing Act 2003 and S182 Guidance. The Licensing authority is aware of the need to avoid measures which deter live music, dancing and theatre - such as imposing indirect costs out of proportion to the income of the licence holder and to the risks presented. Only appropriate, proportionate and reasonable licensing conditions should impose any restrictions on such events.

10.1.3 The licensing committee will support the cultural zones, outdoor eating areas, food led operations, community pubs, live entertainment and protect living conditions in mixed use areas.

APPENDIX A – Licensing Best Practice Measures

Best Practice Measures to be included for consideration, in particular in SSA:
Matters that would normally be expected in operating schedules:

- the adoption of a policy (e.g. Challenge 25) with acceptable proof of ID as per existing Statement of Licensing Policy
- all off sales to be made in sealed containers for consumption away from the premises
- a smoking policy which includes an assessment of noise and litter created by premises users
- the use of plastic or polycarbonate drinking vessels and containers, especially in outside areas or after specified hours
- a policy in relation to searching customers and for drugs, weapons, seized or lost and found property
- use of a refusals book for registering attempts to buy alcohol by under-age persons or refusals to those intoxicated
- the installation of a digital CCTV system by liaison with, and to a standard approved by, Sussex Police
- policies for dispersal of customers which may include signage regarding taxi services' telephone numbers and advice to respect neighbours and minimize noise

Items to which positive consideration would be given:

- membership of Business Crime Reduction Partnership, Pubwatch, Neighbourhood Watch or similar schemes
- use of 'Night Safe' radio system or similar accredited scheme
- regular training and reminders for staff in respect of licensing legislation, policies and procedures; records of which should be properly recorded and available for inspection
- records of regular checks of all parts of the premises in relation to drug use
- systems in place to ensure details of barred clients are exchanged with other operators

- giving an agreed minimum notice of special events (screening of major sports events, birthday parties, adult entertainment, etc.) to relevant authorities and use of appropriate additional measures at such events

Recommend best practice for both on and off premises

- Staff must be aware of the risk of the problem of proxy sales and offer assistance to responsible authorities to deter offences
- Signage on premises should set out legal duties
- Voluntary restriction of high strength alcohol – operating schedules may be used to limit high ABV beers and ciders
- Staff training – in addition to personal licence holders training, staff must be adequately trained for duties
- Challenge 25 would be the norm, particularly in the off licence trade
- Signage – proxy sale – deterrence

5. FINANCIAL & OTHER IMPLICATIONS:

Financial Implications:

- 5.1 The Licensing Act 2003 provides for fees to be payable to the licensing authority in respect of the discharge of their functions. The fee levels are set centrally at a level to allow licensing authorities to fully recover the costs of administration, inspection and enforcement of the regime.

Finance Officer Consulted Michael Bentley

Date: 04/11/24

Legal Implications:

- 5.2 The licensing authority must act to promote the four licensing objectives which are:

- The prevention of crime and disorder
- Public safety
- The prevention of public nuisance
- The protection of children from harm

The licensing authority must have regard to its statement of licensing policy and the guidance issued by the Secretary of State in carrying out its functions.

Lawyer Consulted: Rebecca Sidell

Date: 31/10/24

Equalities Implications:

- 5.3 Diversity is valued and strong, safe communities are vital to future prosperity. Licensing policy aims to protect children from harm including sale and supply of alcohol to children.

Sustainability Implications:

- 5.4 Licensing policy aims to prevent public nuisance and develop culture of live music, dancing and theatre.

SUPPORTING DOCUMENTATION

Appendices:

1. Appendix A – Section 18 (Operating Schedule)
2. Appendix B – Plan of Premises
3. Appendix C – Representations
4. Appendix D – Conditions agreed with Sussex Police
5. Appendix E – Map of area

Documents in Members' Rooms

Brighton & Hove City Council, Licensing Act 2003: Statement of Licensing Policy 2021.

Home Office, Revised Guidance issued under section 182 of the Licensing Act 2003, December 2023.

Public Health Framework for Assessing Alcohol Licensing – January 2022.

Background Documents

Brighton & Hove City Council, Licensing Act 2003: Statement of Licensing Policy 2021.

Appendix A

Section 18 of 21
LICENSING OBJECTIVES
Describe the steps you intend to take to promote the four licensing objectives: a) General – all four licensing objectives (b,c,d,e) List here steps you will take to promote all four licensing objectives together. Strong management controls and effective training of all staff so that they are aware of the premises licence and the requirements to meet the four licensing objectives with particular attention to: a: no selling of alcohol to underage people b: no drunk and disorderly behaviour on the premises area c: no violent and anti-social behavior d: no any harm to children - Clear "Challenge 25" information to prevent the supply of alcohol to under-age drinkers. - CCTV system installed with recording from CONSEC GROUP Ongoing staff training and qualifications, policies, and strategic partnerships with other agencies).
b) The prevention of crime and disorder CCTV System installed to monitor entrance/exit, and other parts of the premises in order to address the prevention of crime objective. A clear and legible notice indicating the normal hours under the terms of the premises license during which licensable activities are permitted
c) Public safety Training and implementation of underage ID checks. A log book or recording system shall be kept upon the premises in which shall be entered particulars of inspections made; The log book shall be kept available for inspection when required by persons authorised by the Licensing Act 2003 or associated legislation.
d) The prevention of public nuisance Prominent, clear and legible notices will be displayed at the exit requesting the public to respect the needs of nearby neighbours and residents and to leave the premises and the area quietly.
e) The protection of children from harm Operate and follow the "Challenge 25" scheme Acceptable ID (a card bearing the PASS hologram, a photographic driving license or a passport) if they wish to buy alcohol. All the details provided in Training Record Book available the cafe. Log Book will be kept upon the premises all the time.

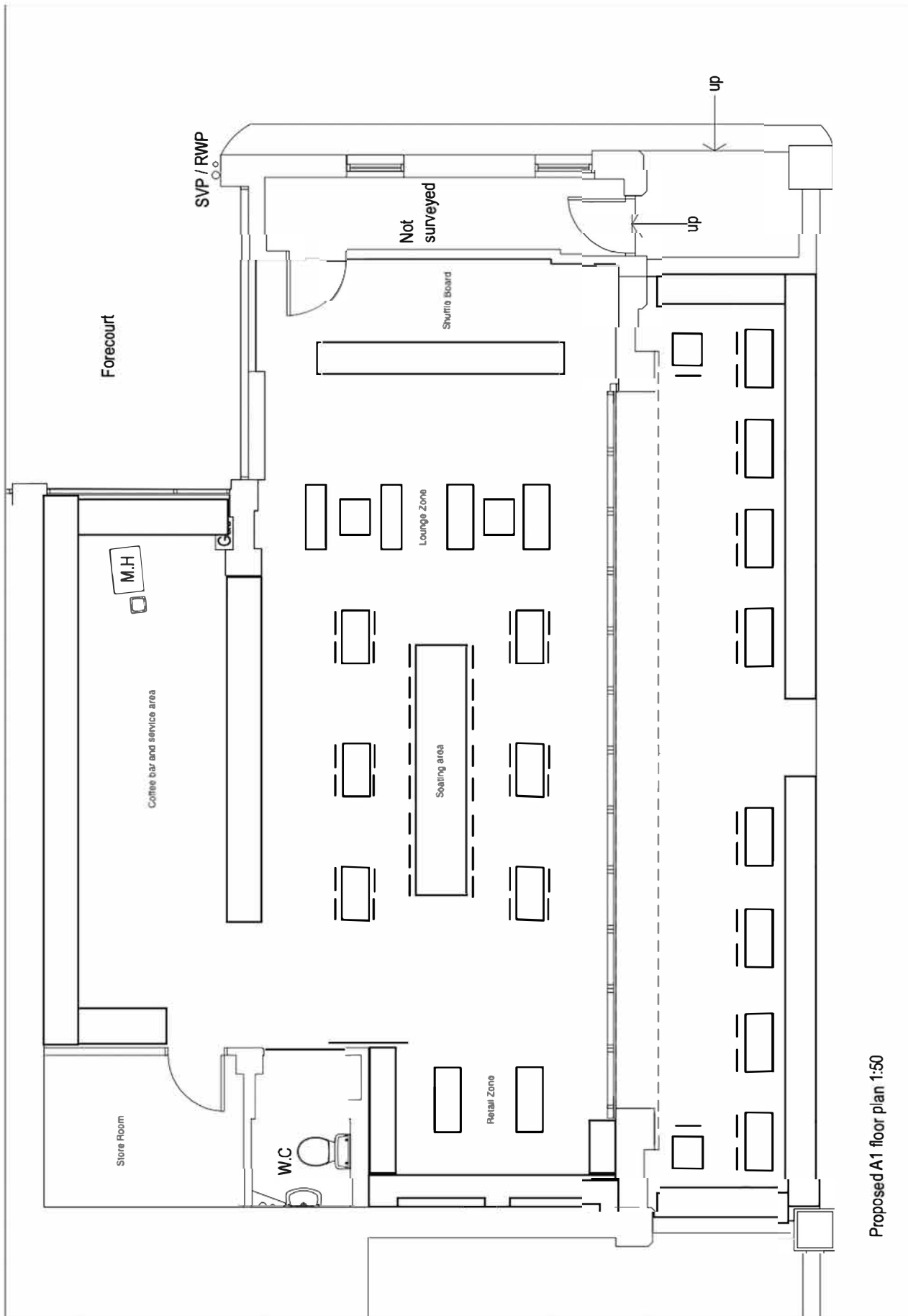

Proposed A1 floor plan 1:50

Appendix C

REP A

From REDACTED

Sent: Tuesday, October 8, 2024 11:10 AM

To: EHL Licensing <ehl.licensing@brighton-hove.gov.uk>

Cc: REDACTED

Subject: License objection

EF CON ENDS: 29.10.2024 VALID PPN (A)

Hi I'm emailing to object to the sale of alcohol until 9pm at 1 Victoria grove in hove.

This is a residential street and there is already a late night bar right next to the site mentioned above, serving alcohol daily until midnight.

I have a **REDACTED** and we already deal with considerable noise pollution not to mention empty glass bottles and vomit outside our home.

It seems excessive to have two establishments on one residential street serving alcohol into the night.

Regards

REDACTED

REP B

From: REDACTED

Sent: Tuesday, October 8, 2024 11:53 AM
To: EHL Licensing <EHL.Licensing@brighton-hove.gov.uk>
Subject: Re: 1 Victoria Grove BN3 2LJ licensing objection

EF CON ENDS: 29.10.2024 VALID PPN (B)

Good morning,

I am writing to raise an objection to the licensing of Fika, 1 Victoria Grove BN3 2LJ, specifically the sale of alcohol until 9pm.

I am a **REDACTED**, and already have trouble with the level of noise coming from **REDACTED** outside keep us awake at night during the weekends.

Fika will be situated closer to where we live, and within this residential area. I am expecting a **REDACTED**, so the threat of extra noise, on top of the bar that's already here, in an already quiet and peaceful residential road, is something I object to.

However, I do not want this to be a reason the establishment cannot continue business. As an alternative suggestion, please consider writing into the agreement that all patrons must remain **inside** in the evenings so as to minimise the noise.

REDACTED

Appendix D

Conditions agreed with Sussex Police

General:

1. Authorised staff employed by Sussex Police in the role of licensing officer shall have the right of access to the licensed premises during hours of operation for the purpose of inspection of the premises and premises records in order to ensure the promotion of the licensing objectives.
2. On-Sales of alcohol permitted only.
3. The sale of intoxicating liquor and other beverages shall be by waiter/waitress service for consumption by persons seated at tables and there will be no vertical drinking.
4. Substantial food shall be available at all times that alcohol is offered for sale on these premises.
5. Food menus offering both hot and cold food options must be clearly displayed within the venue.
6. Alcohol is ancillary to other hot and cold non-alcoholic beverages available on the premises.
7. Outside seating which is included within the licensable area will be subject to a valid table and chairs licence being held. If the terminal hour of the use of this area is earlier than times set within this licence for licensable activities, the earlier time will apply.

For the Prevention of Crime & Disorder:

8. Subject to GDPR guidance and legislation:
 - (a) Digital CCTV and appropriate recording equipment to be installed in accordance with Home Office Guidelines relating to UK Police Requirements for Digital CCTV System (PSDB Publication Number 09/05), operated and maintained throughout the premises internally and externally to cover all public areas, including the entrances/exits to the premises as well as any outside space. The system shall be on and recording at all times the premises licence is in operation.
 - (b) The CCTV cameras and recording equipment must be of sufficient quality to work in all lighting levels inside the premises at all times.
 - (c) CCTV footage will be stored for a minimum of 31 days
 - (d) The management will give full and immediate cooperation and technical assistance to the Police in the event that CCTV footage is required for the prevention and detection of suspected or alleged crime.
 - (e) The CCTV images will record and display dates and times, and these times will be checked regularly to ensure their accuracy.

(f) The management of the premises will ensure that key staff are fully trained in the operation of the CCTV, and will be able to download selected footage onto a disk (or other electronic portable device acceptable to Police e.g. USB) or provide footage via an online link as initiated by Police, without difficulty or delay and without charge.

(g) Any breakdown or system failure will be notified to the police immediately & remedied as soon as practicable. This can be via email - brighton.licensing@sussex.police.uk.

(h) In the event of the CCTV system hard drive being seized as evidence as part of a criminal investigation by Police or for any other reason, the premises will be expected to install a replacement hard drive or a temporary replacement drive as soon as practicable.

9. (a) An incident log will be maintained by the premises showing a detailed note of incidents that occur in the premises. The log will be inspected and signed off by the DPS (or a person with delegated authority) at least once every 4 weeks.
- (b) The logbook should be kept on the premises and be available for inspection at all times the premises are open by authorised officers of the Licensing Authority or the police. An incident will be defined as being one which involves an allegation of a criminal offence.
- (c) The premises shall at all times maintain and operate an age-restricted sales refusals recording system (either in book or electronic form) which shall be reviewed by the Designated Premises Supervisor at intervals of no less than 4 weeks and feedback given to staff as relevant. This refusals book should be kept on the premises and be available for inspection at all times the premises are open by Sussex Police, officers of the local authority and officers from the Trading Standards team. The log will be kept for a minimum of twenty-four (24) months.

Public Safety:

-

For the Prevention of Public Nuisance:

-

For the Protection of Children from Harm:

10. The premises will operate a "Challenge 25" policy whereby any person attempting to buy alcohol who appears to be under 25 will be asked for photographic ID to prove their age. The recommended forms of ID that will be accepted are passports, official Photographic Identity Cards issued by EU states bearing a hologram or ultraviolet feature, driving licences with a photograph, photographic military ID or proof of age cards bearing the 'PASS' mark hologram. The list of recommended forms of ID may be amended or revised with the prior written agreement of Sussex Police, the Licensing Authority and Trading Standards without the need to amend the licence or conditions attaching to it.
11. Signage advertising the "Challenge 25" policy will be displayed in prominent locations in the premises.
12. The Premises Licence Holder shall ensure that all staff members engaged or to be engaged, in selling alcohol at the premises shall receive the following induction training. This training will take place prior to the selling of such products:

- The lawful selling of age restricted products.
- Refusing the sale of alcohol to a person who is drunk.

Further verbal reinforcement/refresher training covering the above will be carried out thereafter at intervals not to exceed 8 weeks, with the date and time of the verbal reinforcement/refresher training documented. All such training undertaken by staff members shall be fully documented and recorded. All training records shall be made available to Sussex Police, officers of the local authority and officers from the Trading Standards team upon request.

Appendix E



